

	MODEL NO.	AMS195-0501200FV	SHEET NO	AP20206236853
	DESCRIPTION	Switching Adaptor	ISSUED DATE:	2020/02/26

APPROVAL SIGNATURE
DATE:

Customer :

Model No : AMS195-0501200FV

Part No : YDS-8804-1-R Revision: A

Type : EU Adapter

Efficiency Level: VI

Input Voltage	100-240VAC 50/60 Hz	Output Voltage	5V DC 1.2A 6W
Output Cable	內建式 USB 1 Port A - Type		
AC Plug	EU Plug	Packaging	白盒 90X30X70mm

亞達特科技股份有限公司

2F.-5, No.315, Sec. 3, Minsheng Rd., Banqiao Dist., New Taipei City 220, Taiwan

TEL: 02-22587990 FAX:02-22586990

<http://www.adtweb.com.tw>

ELECTRICAL REQUIREMENTS

DESIGNED NO.	YDS-8804-1-R	DATE.	2020/2/19
--------------	--------------	-------	-----------

1. SCOPE :

1-1.This specification describes the physical, functional and electrical characteristics of the 6 watts, single output 5 V 1.2 A switching power supply.

Description

<input checked="" type="checkbox"/> Wall Mount	<input type="checkbox"/> Desk-Top
<input type="checkbox"/> Open Frame	<input type="checkbox"/> Others

2. INPUT CHARACTERISTICS:

2-1.Input Voltage & Frequency

Item	Min.	Normal.	Max.	unit
Input voltage range	90	100-240	264	Vac
Input frequency range	47	50/60	63	Hz

2-2.Input current

Input current should be lower than 0.3 Arms full-load at 100-240 Vac input voltage conditions.

2-3.Inrush Current

At Full Load ,25°C , Cold Start ;

No Component Over Stress and No Fuse Blow No Damage To The Power Supply ◦

2-4.Stand-by Consumption & Average Efficiency In Active.Comply with following regulation:

Regulations		Efficiency Level	For		
U.S.DOE 10 CFR Part 430		Level VI		<input type="checkbox"/>	Basic Voltage model
EU Code of Conduct Version 5,Tier 2		Level VI		<input checked="" type="checkbox"/>	Low Voltage model
<input checked="" type="checkbox"/>	(EU)2019/1782	Level VI			

Stand-by consumption 0.1 W Max.

Average Efficiency in active 75.003% % Min.

※ All test condition is based on input voltage 115/230Vac 60/50Hz at ambient 25°C after 30 minutes in full load.

3. OUTPUT CHARACTERISTICS:

3-1.Output Characteristics

Output voltage, load current, voltage regulation and output noise of power supply should meet the specifications, which defined on the tables below:

Item	Min.		Rated		Max.		Test conditions
Output Voltage	4.75	Vdc	5.00	Vdc	5.25	Vdc	NO Load
Output Voltage	4.75	Vdc	5.00	Vdc	5.25	Vdc	FULL Load
Output Load	0	A	/		1.2	A	
Turn on Delay Time	/				3	S	Full Load & 90Vac/63Hz and 264Vac /47Hz @ Ta=25°C
Hold Up Time	10	m S	/				Full Load & 115Vac/60Hz and 230V/50Hz, @Ta=25°C
Capacitance load	/		1000UF		/		100 ~240Vac, Full load
Ripple & Noise	Max.		200		mVp-p		Full Load & 115Vac/60Hz and 230V/50Hz, @Ta=25°C (Note 1)

Note 1: Ripple voltage measurement is tested with an oscilloscope set at a 20M Hz bandwidth & output wire 100 mm terminated with 0.1uF ceramic capacitor & parallel with 10uf low ESR electrolytic aluminum capacitor at full load.

4. Output Protection :

Item	Max.		Test conditions
Over current protection (OCP)	2.40	A	115Vac/230Vac 60Hz/50Hz, Full Load.
Over voltage protection (OVP)	10	V	
Short Circuit Protection(SCP)	The adapter will sustain a continuous short circuit at the output connector without damage or exceeding the case temperature limit defined in safety standard and when output short happened then should be down output voltage. Auto-recovery mode.		

5. Environment Section

Item	Min.		Max.		Remarks
Operating Temperature :	0	°C	40	°C	Unit shall comply electrical & machanical requirements when it recovers to normal ambient temperature after removed from strorage conditions.
Operating Humidity :	10	%RH	90	%RH	
Storage Temperature :	-10	°C	60	°C	
Storage Humidity :	5	%RH	95	%RH	

6. Dielectric Withstand Voltage(Hi-pot)

The Adapter shall be applied 3000 Vac for 60 seconds or 4242 Vdc for 60 seconds between AC input terminals and output terminals. The cut off current is specified \leq 10 mA.

(Note: In mass production, the Hi-pot voltage as above can be increased 20%, and the test time can be reduced to 3 seconds to test)

7. Insulation Resistance

Primary to secondary : \geq 10 M ohm. 500 VDC.

8. EMI Requirement

The adapter complies with :

<input type="checkbox"/>	FCC Part 15 Class B	<input checked="" type="checkbox"/>	EN55032 Class B	<input type="checkbox"/>	J55032 Class B
<input type="checkbox"/>	AS/NES 3548 Class B	<input type="checkbox"/>	CNS13438 Class B	<input type="checkbox"/>	ICES-003 Class B
<input type="checkbox"/>	GB/T9254 Class B	<input checked="" type="checkbox"/>	EN55024 Class B		

9 ESD: \pm 8 KV air discharge, \pm 4 KV contact discharge

10 PLD (lightning surge IEC 61000-4-5)

(1) Common Mode +/- KV (12 ohm) . Class I (line to earth , neutral to earth , line to neutral)

(2) Differential Mode +/- 1 KV (2 ohm) . Class II (line to neutral)

11. Safety Conforming

Type	Standard
UL	UL60950-1
UL	UL1310
cUL	CAN/CSA C22.2 No.60950-1
cUL	CAN/CSA C22.2 No.223
GS	EN60950-1
PSE	J60950-1
BSMI	CNS14336-1
GS	EN60065:2002+A1:2006

Type	Standard
CE	IEC60065
CB	IEC60950-1
SAA	AS/NZS: 60950-1
CCC	GB4943.1
<input checked="" type="checkbox"/> V CE	EN62368-1
KETI	K 60950-1
CB	IEC60065
PSB	IEC60950-1

12. Mechanical:

12-1.Dimension

Body: 61 mm (L) \times 28.5 mm (W) \times 42 mm (H) reference only (Detail Refer Page 8).

12-2.Output Cord

Plug: PIN1:+,PIN4:-,PIN2;PIN3:Shrot mm

Wire: N/A mm

12-3.Weight

Net Weight (Approx): 52,240 \pm 5% mg.

12-4.AC Plug

VDE Type.

MECHANICAL REQUIREMENTS

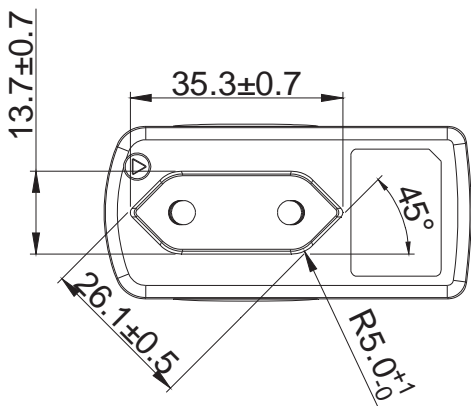
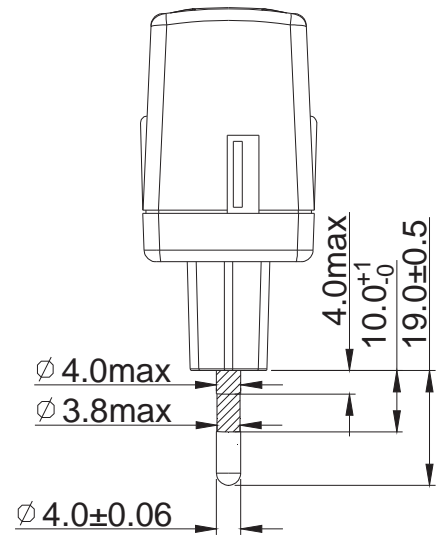
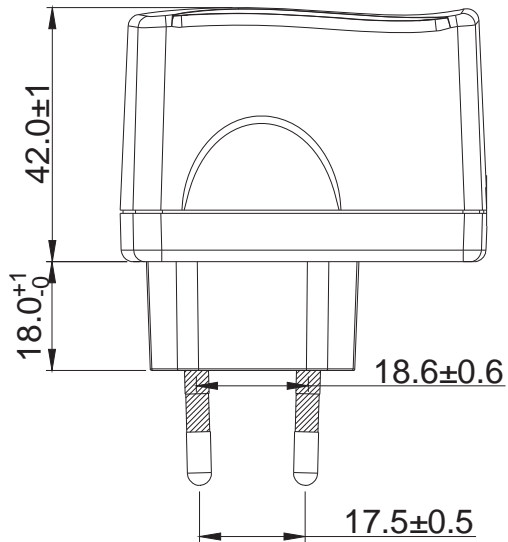
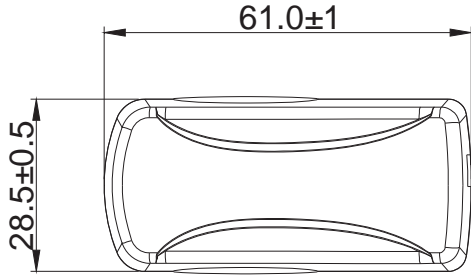

DESIGNED NO.	YDS-8804-1-R			
COLOR	Black			
MATERIAL	PLASTIC	To creating new drawing SPEC.	2020/2/19	鄭麗娥
UNIT	mm	DESCRIPTION	DATE	REVISER

NAMEPLATE

20.5⁺⁰_{-0.2}

14.5-0.2

SWITCHING ADAPTER
 Model No: AMS195-0501200FV
 Input: 100-240V~50/60Hz 0.3A
 Output: 5.0 V = 1.2 A 6.0W LPS

VI Made in China

C2.0

R7.0*3

Background: Black

Letters: White

DESIGNED NO.	YDS-8804-1-R			
COLOR	黑底白字		2020/2/26	鄭麗娥
MATERIAL	0.16t PET	To creating new drawing SPEC.	2020/2/19	鄭麗娥
UNIT	mm	DESCRIPTION	DATE	REVISER

BAR CODE

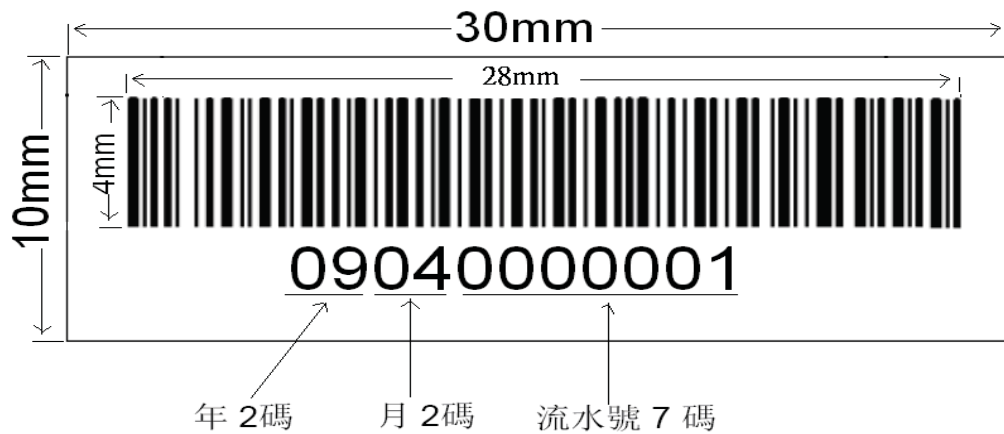
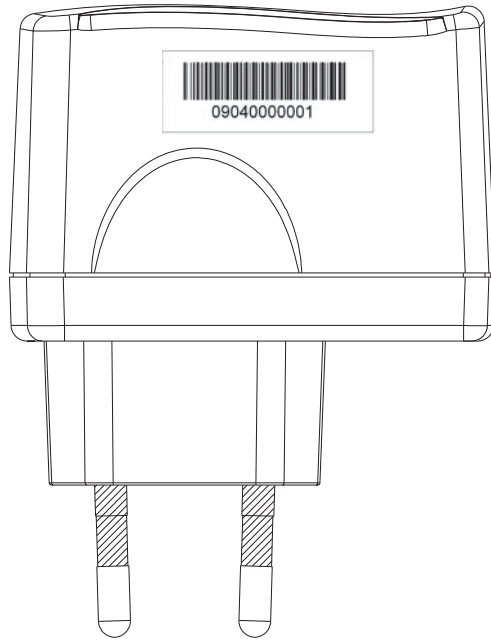

- (1)菲林印刷
- (2)碼紋型號:CODE 128
- (3)字型:SWIS721BT
- (4)貼於成品上
- (5)未標公差±0.5mm

DESIGNED NO.	YDS-8804-1-R			
COLOR	白底黑字			
MATERIAL	PET	To creating new drawing SPEC.	2020/2/19	鄭麗娥
UNIT	mm	DESCRIPTION	DATE	REVISER